



CROWN

EVENTS & CONFERENCES
MELBOURNE



GARDEN ROOM

GARDEN ROOM

Stylish and impeccably appointed, the Garden Room located in Crown Towers, is ideal for an intimate or special occasion. It has been designed to hold up to 120 guests in a Banquet style setting or can be divided into three versatile function spaces. With Melbourne Skyline views featuring Crown's signature flame towers, and elegant interiors including plush custom made carpets, wall panelling and warm neutral tones, the Garden Room offers a beautiful setting for your next event.

Encore Event Technologies

Encore Event Technologies is a leading audio visual provider and Crown Melbourne's in house audio visual partner. Encore Event Technologies will assist in the delivery of technical production, lighting, event design and styling ensuring a stress free, seamless and highly successful event or meeting.

Contact

8 Whiteman St Southbank
 Victoria 3006 Australia
 Phone: +61 3 9292 6222
 Email: event_sales@crownmelbourne.com.au
crowneventsandconferences.com.au

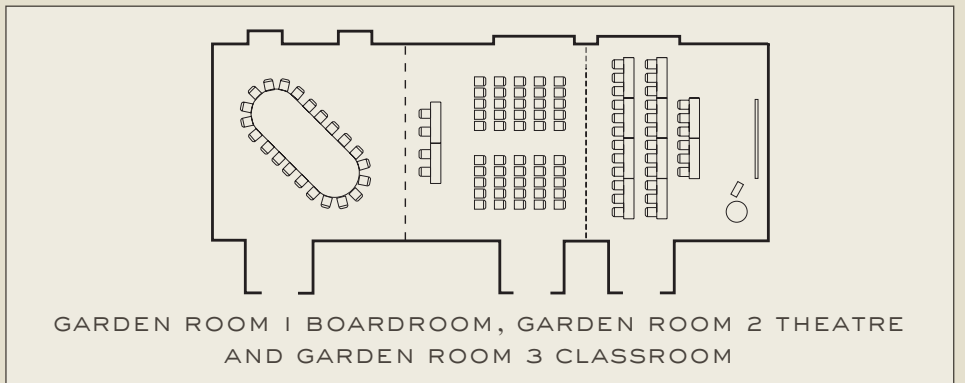
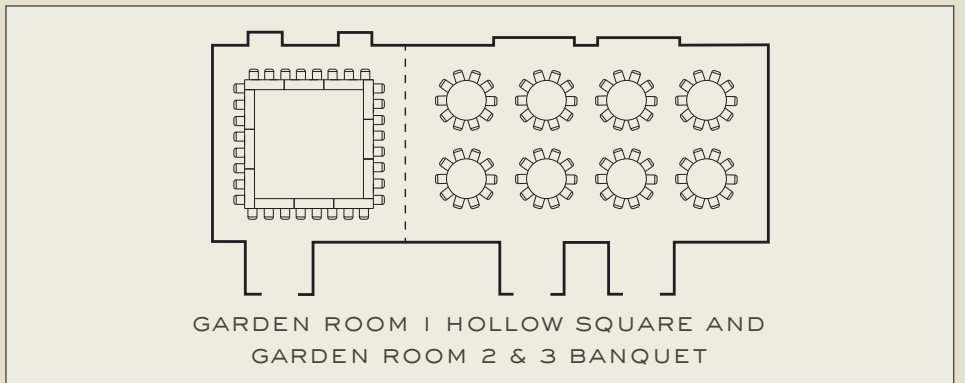

Room	Width (m)	Length (m)	Area (m ²)	Height (m)	Banquet	Dinner Dance	Wedding Reception	Cocktail Reception	Theatre	Cabaret/ Open Ended	U Shape	Board Room	Class Room
Garden Room	8	24	192	5	120	80	80	150	190	96	72	N/A	130
Garden Room 1	8	8	64	5	40	20	20	50	50	32	24	22	30
Garden Room 2	8	8	64	5	40	20	20	50	50	32	24	22	30
Garden Room 3	8	8	64	5	40	20	20	50	50	32	24	22	30
Garden Room 1 & 2	8	16	128	5	80	60	50	100	100	64	40	42	40
Garden Room 2 & 3	8	16	128	5	80	60	50	100	100	64	40	42	40